



Process to transfer your software license to another computer.

Prerequisites: RASWin Licensing Tool. Could be found on RTE folder where RASWin is installed a shortcut to it is also present in the RASWin application menu from Windows.

It also could be downloaded from:

<http://www.raswin.eu/raswinupdates/RASWinHasp.zip>

RASWin installed on both computers, source and destination.

- 1)** Execute tool **RASWinHasp.exe** in the machine you want to transfer the license.
- 2)** In the dialog select tab **Transfer License**
- 3)** Select a destination file name for your recipient machine by entering a name or clicking the [...] button.
- 4)** Press button **Collect and Save Information**. This will generate a file that you should copy to the machine where you've the active license

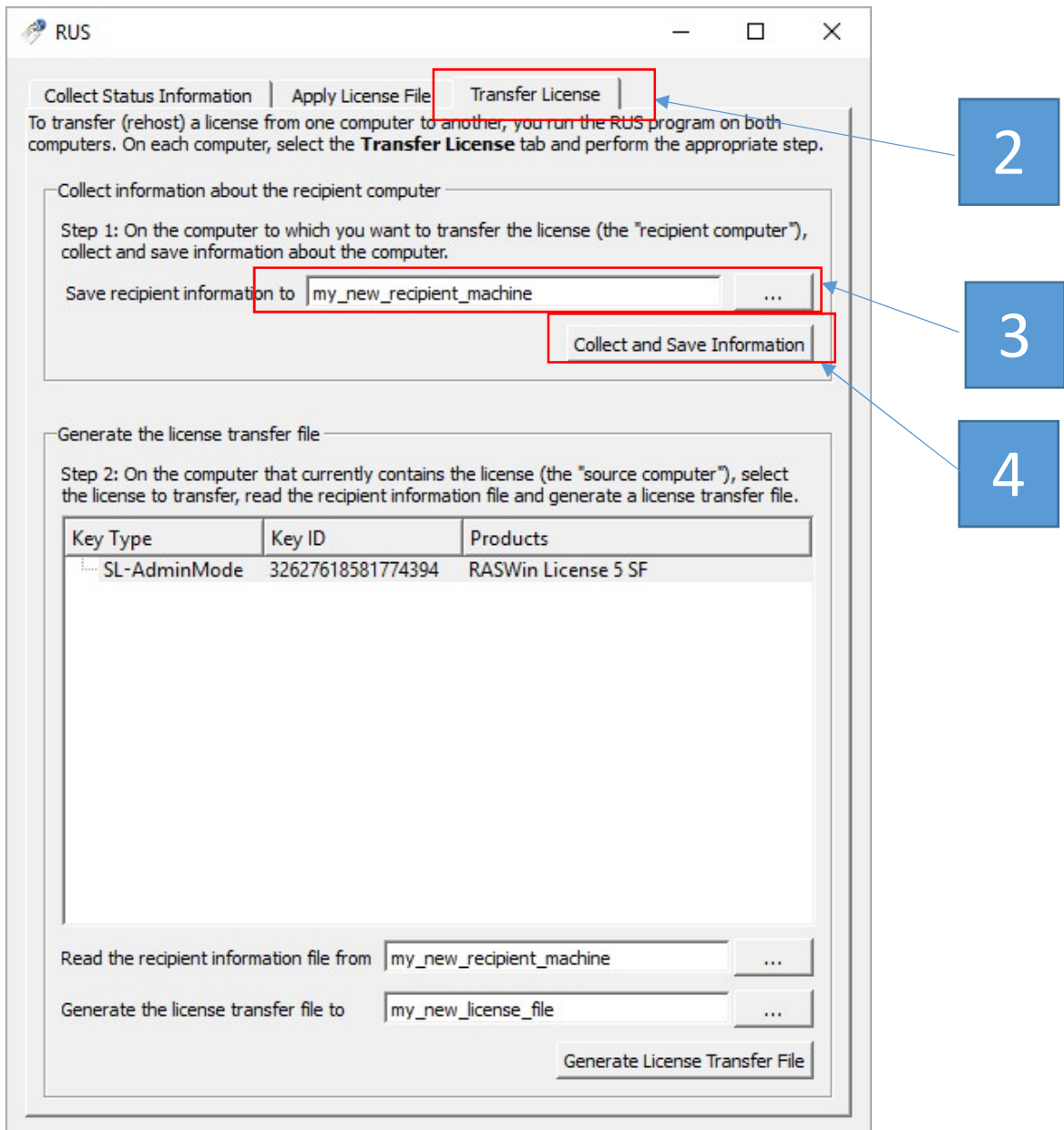

- 5) Go to the machine that currently has the license and also execute **RASWinHasp.exe** tool.
- 6) In the dialog select tab **Transfer License**
- 7) Load the recipient computer collected data file by clicking in the button [...] near the button **“Read the recipient information file from”**.
- 8) Give a new name to your new license data or browse your machine for where to put the new license file.
- 9) Click the **Generate License Transfer File**

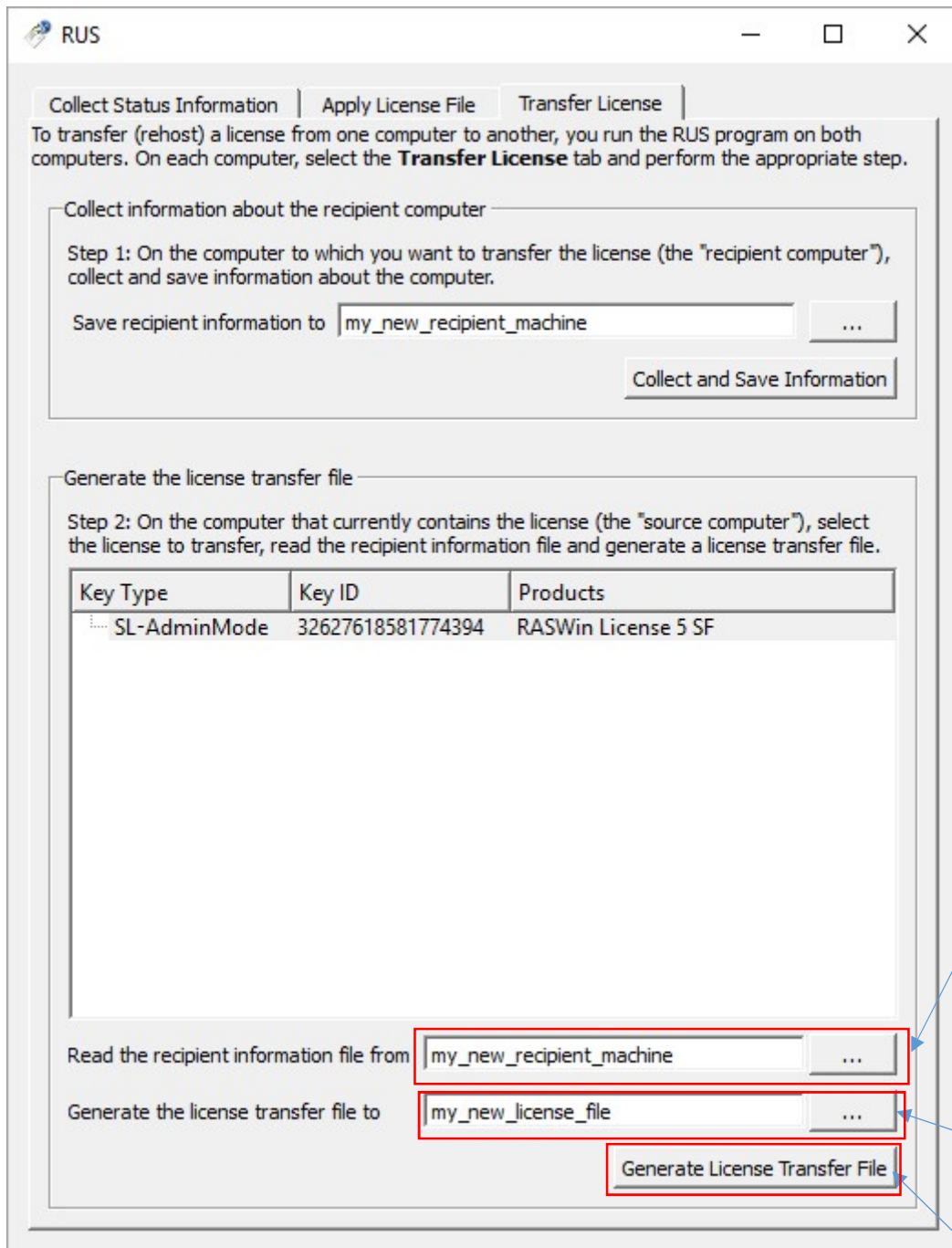

- 10) Your new license file will be generated, copy it to your new machine
- 11) Execute tool **RASWinHasp.exe**
- 12) In the dialog select tab **Apply License File**.
- 13) In the bottom of the dialog press the browse file button [...] and locate the newly generated V2C file.
- 14) Click **Apply Update**.

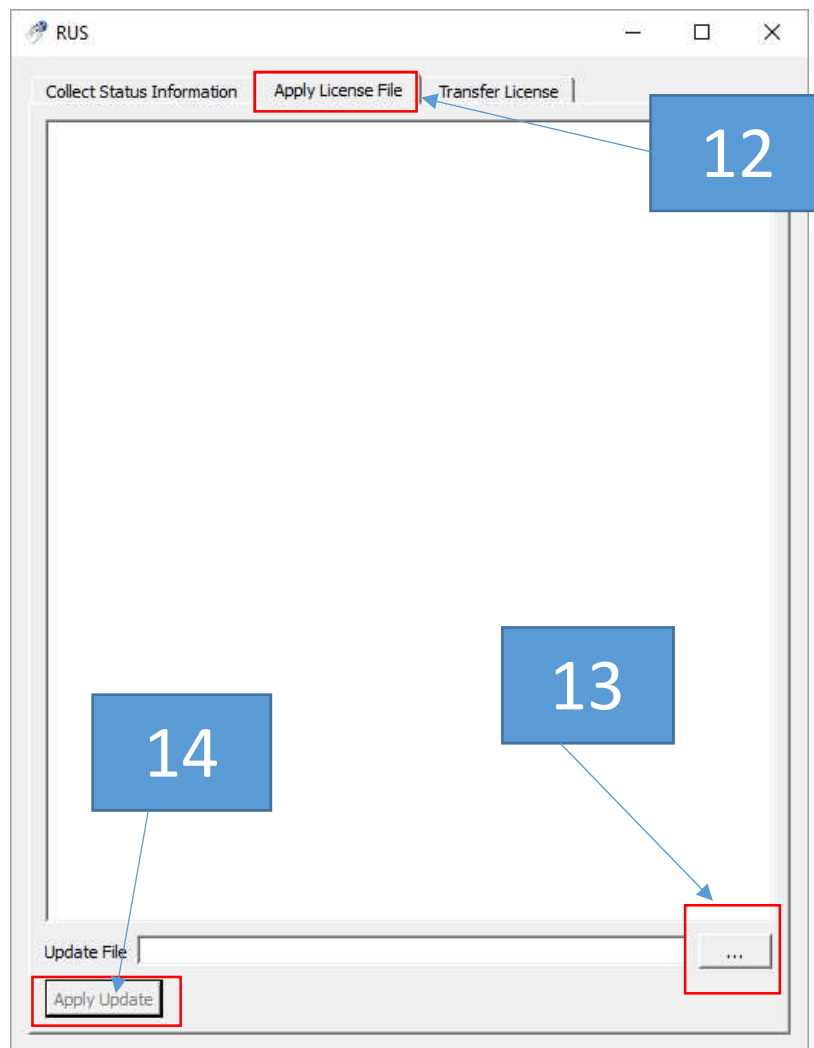

After that your license should be installed and you can run RASWin normally.